

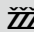

3.2

64!64I  J

64F

(NG) 10 32
350TSd
650L/_ [

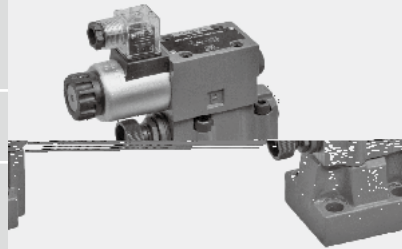

02	-		
03	-	DIN24340E	ISO 6264
04	-		
05	- 5		
06	-		
07-09	- 2		
10	‰		
	‰		
	-	(DBW)	

DB	DBW			(DB)	(DBW)			(DB)
		(3)	(1)		(2)			

DB

A		(3)			(4)	(5)	(6)	(7)	(3)
	(2)	(8)		A		(9)	(8)	(9)	
		(10)	(6)	A		(3)			(7)
(11)	(8)	(12)		-DB..L5X..Y-		(14)		(4)	(5)
(3)		A	B				X(15)		(
)								

03

DBW

	DB				(16)	(3)		
--	----	--	--	--	------	-----	--	--

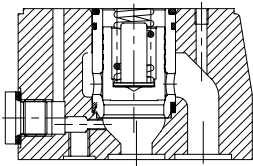

()DBW.../.S..R12

(17) B2 B1

(16) ()

(18)

± 1.2_ _

(...R12..)

03

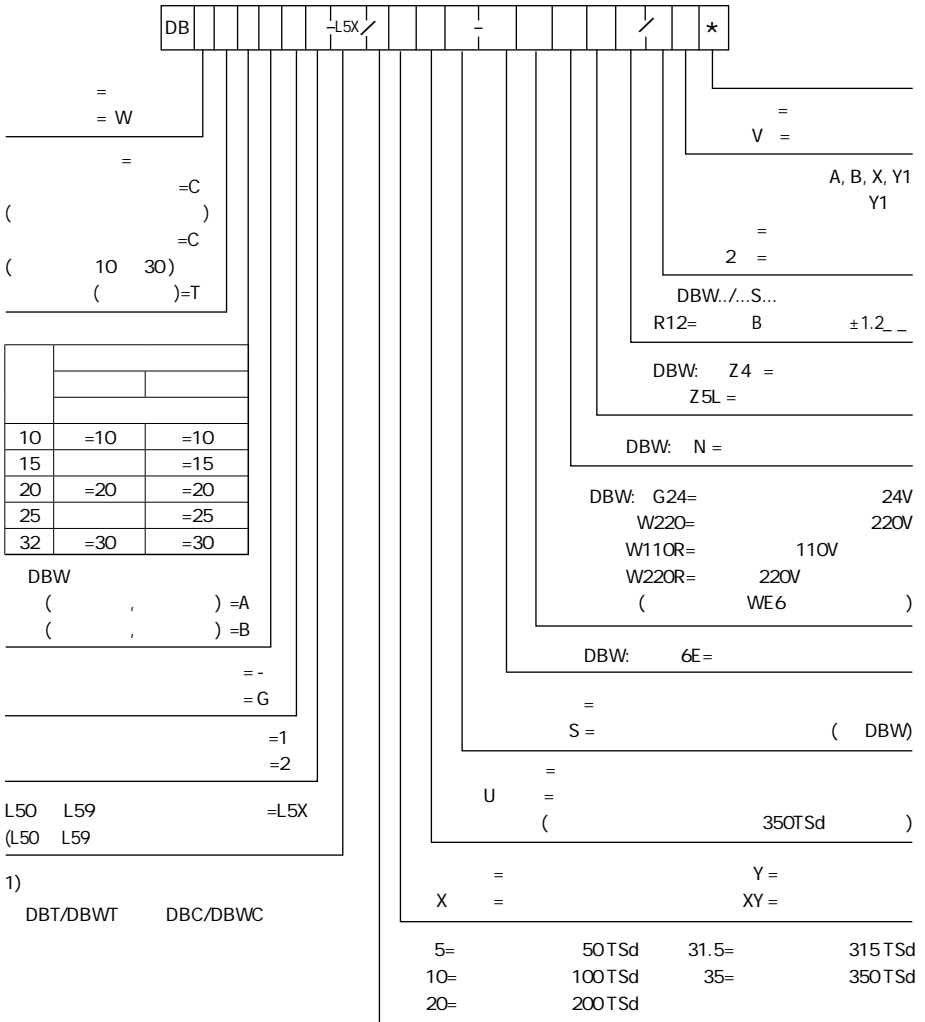

03

1

DBD

DBD

2 U

(HLP46 =40 f 5)

B

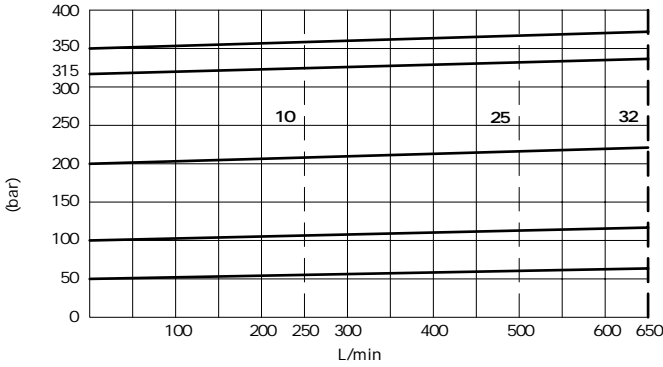

!

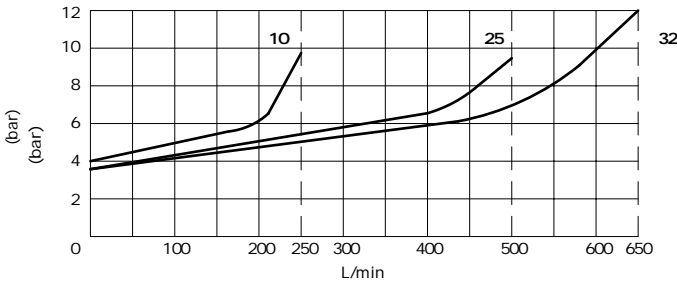

!

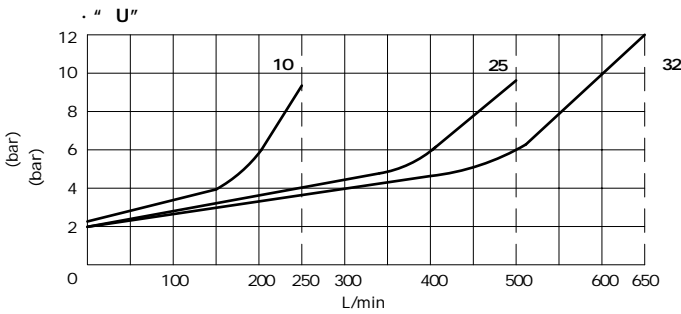

(--)

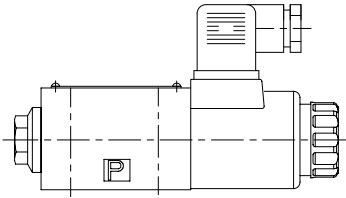

03

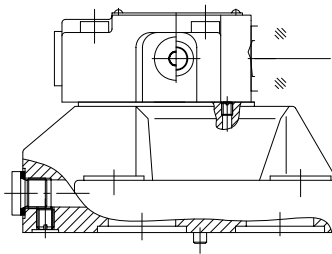

(--)

03

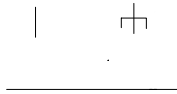

G1/4
M14x 1.5

G1/4
M14x 1.5

G1/4
M14x 1.5

DB..G..L5X

DB..G..30

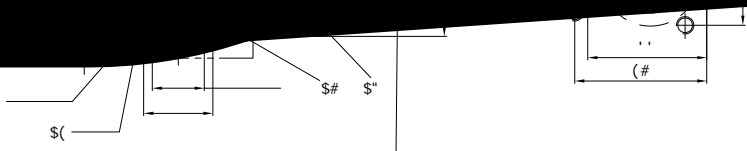

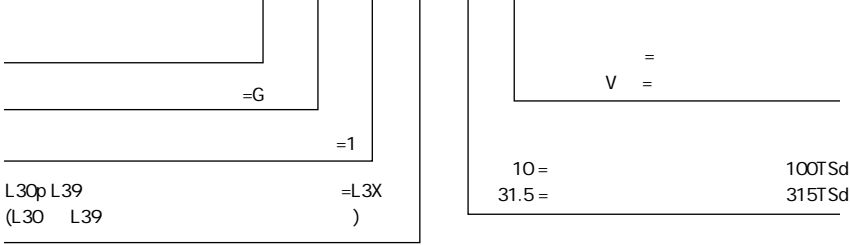
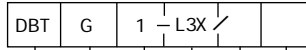

03

